

FABER

Living the Italian Style

WALL FAN

Model: FWF VENTO GEN 2 1635R

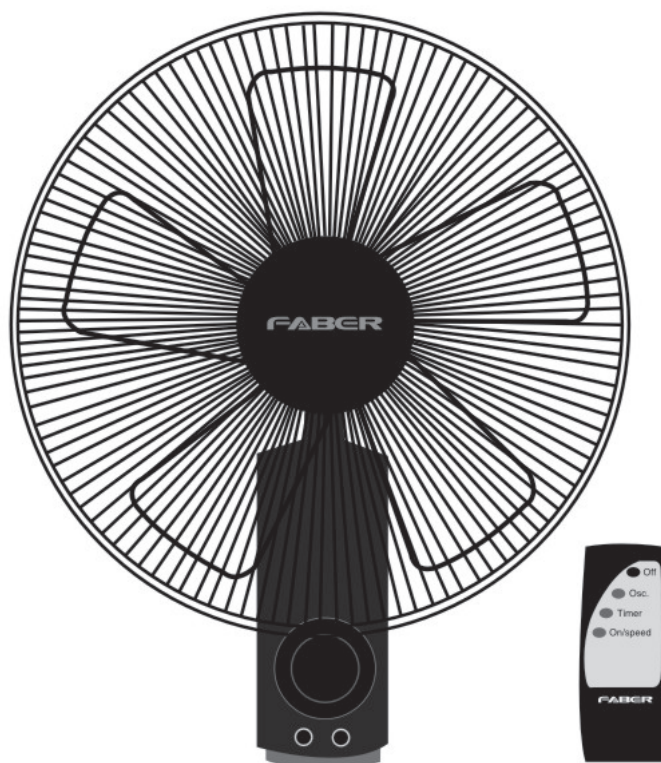

WALL FAN OPERATING INSTRUCTIONS

Important Safe Guards

When using an electrical appliance, basic safety precautions must always be observed, including the following:

Read all Instructions before Using

Warning: To reduce the risk of fire, electrical shock, and injury to person, the following must be adhered to:

1. This appliance is not intended for use by persons (including children) with reduced physical, sensory or mental capabilities, or lack of experience and knowledge, unless they have been given supervision or instruction concerning use of the appliance by a person responsible for their safety.
2. Children should be supervised to ensure that they do not play with the appliance.
3. The product is for household use only.
4. Connect the appliance to a single-phase AC supply voltage, specified on the rating plate.
5. Never leave the fan un-attended while it is in use. Always turn the fan to the "OFF" position, and unplug the fan from the electrical outlet socket, when not in use.
6. Extreme caution is necessary when any fan is used by or near children, invalids or elderly persons, and whenever the fan is left operating un-attended.
7. The fan cord must not be placed under carpets, or covered with throw rugs, runners or similar. Arrange the cord away from the traffic area, and where it will not be tripped over.
8. Do not operate the fan with a damaged cord or plug, or after the fan malfunctions, or has been dropped, or damaged in any manner.
9. If the supply cord is damaged, either the manufacturer, or the service agent, or a similarly qualified person, must replace it, to avoid a hazard.
10. Use the fan in a well ventilated area. While in use, ensure that the airtakes or exhaust openings are not blocked un-expectedly, and the fan distance from the wall or corner must be no less than 20cm. The fan should not be placed below or besides any curtains or similar
11. To avoid mechanical danger when in use, do not insert, or allow fingers, or any other objects into the grill. Do not block the air-intakes or the exhaust openings in any manner.
12. The fan must only be placed, and used on a flat dry floor.

For household use only
Save these instructions

Specifications

MODEL NO	SPEC.	RATED VOLTAGE	RATED POWER
FWF VENTO GEN 2 1635R	40cm	220-240V~ 60Hz	60W

Structure Diagram



FWF VENTO GEN 2 1635R



Installing and using

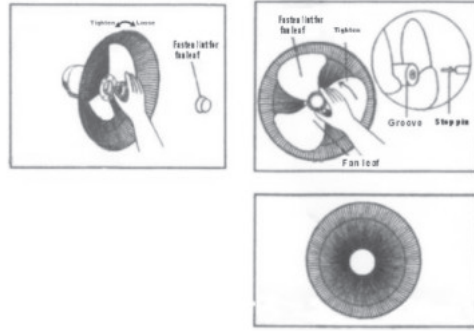

Assemble fan blade

1. Assemble guard cover and shroud ring

Tighten back cover enclosure to the motor by fastener(Pay attention to direction of rotation). Place

joint of shroud ring downwards and cover the deep groove of shroud ring to the circle side ring of back cover enclosure, then tighten the bolts at the position of joint properly by nut.

2. Install fan blade

While installing fan blade, please wedge groove on the back of fan blade on spacer pin of the output shaft of motor, then tighten the fixing nut of fan blade anticlockwise.

3. Assemble front cover

Insert the circle of front cover into the groove of shroud ring, which has been fixed to the back cover. Finally fasten the bolts into screw of the joint of shroud ring.

Function introduction

1. Setting of wind direction

The angle of the fan head is adjustable, it can facing upwards and downwards by slightly lift or press the cover.

2. Setting of shaking

Press the shaking button and the head starts to rotate, then press it again, the fan will stop rotating.

3. Setting of wind speed

Totally there are 3 speeds, you only need to press speed button repeatedly, the wind speed will be change from 1 to 3, if you press it one more time, then it will turn back to 1 speeds again.

4. Setting of wind mode

There three wind mode: normal, natural and sleeping. You can change the wind mode by press mode button repeatedly.

5. Setting of timer

The fan can work at 30mins, 60mins, 120mins and 240mins by setting the timer.

Remarks: The function of Item 2,3,4,5 are also can be relized by remote cotrol.

Solution to simple failure

When starting the fan, the fan blade doesn't work, please check whether the power plug has really inserted into the socket or the cover has distorted, which has touched the fan blade. If sound the noise when starting the fan, please check the unit as following:

1. Fan blade has been tight installed into the output shaft of motor.
2. Groove on back of cover has matched the inserting groove on the output shaft.
3. There are tiny defective edge ring existing around the fan blade.
4. The cover has distorted, which has touched the fan blade.

Operating Instructions

1. Before using the fan, make sure that it is on a flat and stable surface. Damage may occur if the fan is placed on an incline or decline.
2. Set all the switches to the “OFF” position, and then insert the plug directly into a standard AC socket-outlet. Be sure that the plug fits tightly into the socket-outlet.
3. Using the remote control to select the following functions:
 - select speed 1.2.3
 - select oscillate function.
 - select timer from 0.5hr to 7.5hr
4. wall fan can be operated without remote control by selecting functions on the fan control .
5. If you want to increase the blast area in your room, press the swing button down, and the fan will oscillate and blast your room in large scope. To stop oscillating, just pull out the swing button. Moving the fan head either up or down will change the direction of the wind.
6. To completely shut the fan off, turn all the controls to the “OFF” position, and then remove the plug from the socket-outlet.

Cleaning / Maintenance Instructions

To safely take care of your fan, please remember to follow these instructions below:

1. Always remove the plug from the socket-outlet, and allow the fan to stop completely before cleaning the fan.
2. Do not allow water to drip on, or enter into the fan housing.
3. Always use a soft cloth, moistened with a mild soap solution.
4. Do not use any of the following agents as a cleaner: Gasoline, Thinners, or Benzene.
5. In case of malfunction or doubt, do not try to repair the fan yourself, it may result in a fire hazard or electric shock.

FAN Cleaning

Clean the fan grill, housing and base with a soft damp cloth. Do not attempt to remove the fan blades. Please use caution around the motor housing area. Do not allow the motor, or other electrical components to be exposed to water.

FAN Storage

When storing your fan in the off-season, it is important to keep it in a safe dry location. It is important to protect the fan head from any dust. We strongly recommend using the original box, when storing the fan away.

Conformity with Directives

This product is CE marked to denote conformity with Directives 73/23/EEC (Low Voltage) and 89/336/EEC (Electro-magnetic Compatibility), as amended.

Correct Disposal of this product



This marking indicates that this product should not be disposed with other household wastes throughout the EU. To prevent possible harm to the environment, or human health from uncontrolled waste disposal, and re-cycle it responsibly to promote the sustainable re-use of material resources. To return the used device, please use the return and collection systems, or contact the retailer where the product was purchased. They can take the product for safe environmental re-cycling.