

FABER

TABLE FAN

FTF BLISS 3012GN

FTF BLISS 3112WH

FTF BLISS 3016GN

FTF BLISS 3116WH

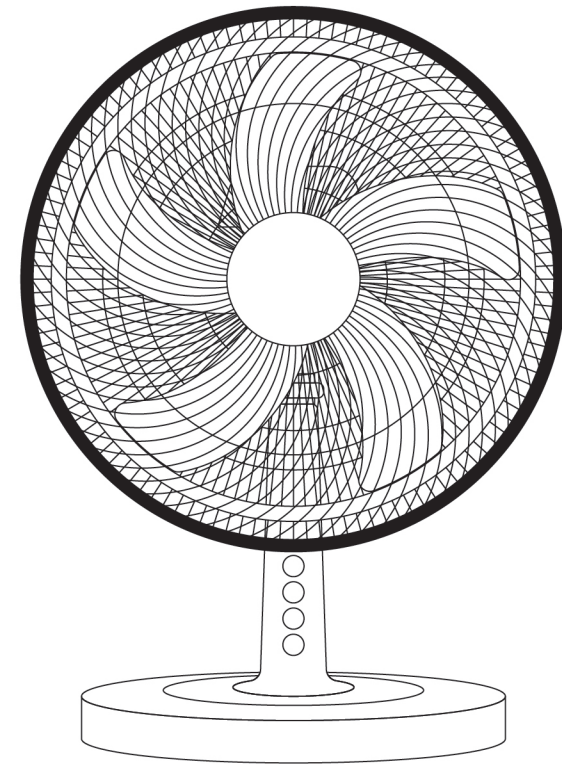

TABLE FAN

Correct Disposal of this product



This marking indicates that this product should not be disposed with other household wastes throughout the EU. To prevent possible harm to the environment or human health from uncontrolled waste disposal, recycle it responsibly to promote the sustainable reuse of material resources. To return your used device, please use the return and collection systems or contact the retailer where the product was purchased, They can take this product for environmental safe recycling.



Dibuat untuk dan diedarkan oleh :
FIMACO SDN BHD
8-2,WISMA FIAMMA
No.20,Jalan 7A/62A,
Bandar Manjalara, 52200 Kuala Lumpur, Malaysia.
CUSTOMER CARE CENTRE :+603 6279 8888

CE CB

VOLTAGE : 220~240V FREQUENCY : 50/60Hz

INSTRUCTIONS MANUAL

PLEASE READ THIS INSTRUCTIONS MANUAL CAREFULLY BEFORE USING THIS PRODUCT

BEFORE OPERATING THIS PRODUCT, READ, UNDERSTAND, AND FOLLOW THESE INSTRUCTIONS.

>BEFORE FIRST USE

Read and follow all the instructions in this "Use and Care" manual even if you feel you are familiar with the products, and find a place to keep it handy for future reference.

Your attention is drawn particularly to the sections concerning "SAFE GUIDE" AND "WARRANTY" statements.

For your convenience, attach you purchase receipt and attach to this booklet and retain in the event that warranty protection is required.

NOTE: The rating of this product (as marked on the product identification plate) is based on specific loading tests. Abnormal use or the use of other recommended attachments may draw significantly less power.

>SAFE GUIDE

PLEASE READ ALL INSTRUCTIONS CAREFULLY BEFORE USING THE PRODUCT.

When using the electrical appliance, the following basic safety precautions should always be followed.

WARNING-to reduces the risk of fire, electric shock or iniury to persons:

> Always operate the product from a power source of the same voltage, frequency and rating as indicated on the product identification plate.

> Do not use this fan with any solid state speed control device the risk of electric shock.

> This appliance is not intended for use by persons (including children) with reduced physical, sensory or mental capabilities, or lack of experience and knowledge, unless they have been given supervision or instruction concerning use of the appliance by a person responsible for their safety.Children should be supervised to ensure that they do not play with the appliance.

> Do not leave the fan running unattended.

> Do not operate the product if it is dropped, damaged or showing signs of product malfunction. Do not operate the product with a damaged plug or cord. Return the complete product to the place of purchase for inspection, refund or replacement.

> Do not immerse or expose the product or flexible cord to rain, moisture or any other liquid.

> This product should not be used in the immediate vicinity of water, such as bathtubs, washbowls.swimming pools, etc. . Where the likelihood of immersion or splashing could occur.

>Never install the unit where it could be subject to:

- Heat sources such as radiators, heat registers, stoves or other products that produce heat.

- Direct sunlight

- Excessive dust

- Lack of ventilation, such as a cabinet or bookcase

- Uneven surface

> Switch off and unplug from outlet when the product is not in use, before assembling or disassem-bling parts and before cleaning. Fully assemble the fan before switching on.

> Avoid contact with moving parts. Do not insert any body parts (e.g. finger) or objects through thefan grille when the fan is operating.

> Do not cover the grille, or operate in close proximity to curtains, etc.

>This product is intended for normal domestic/household use only.

>Always disconnect the fan when moving it from one location to another.

> The use of attachments or accessories not recommended or sold by the product distributor may cause personal or property hazards or injuries.

READ AND SAVE THESE INSTRUCTIONS FOR FUTURE REFERENCE

PERFORMANCES

Model	Fan Size	Size	Rated Voltage	Rated Frequency	Rated Power
	(CM)	(INCH)	(V)	(Hz)	(W)
FTF BLISS 3012GN	35	12"	220-240	50/60	45
FTF BLISS 3112WH	35	12"	220-240	50/60	45
FTF BLISS 3016GN	40	16"	220-240	50/60	60
FTF BLISS 3116WH	40	16"	220-240	50/60	60

>FEATURES OF THIS PRODUCT

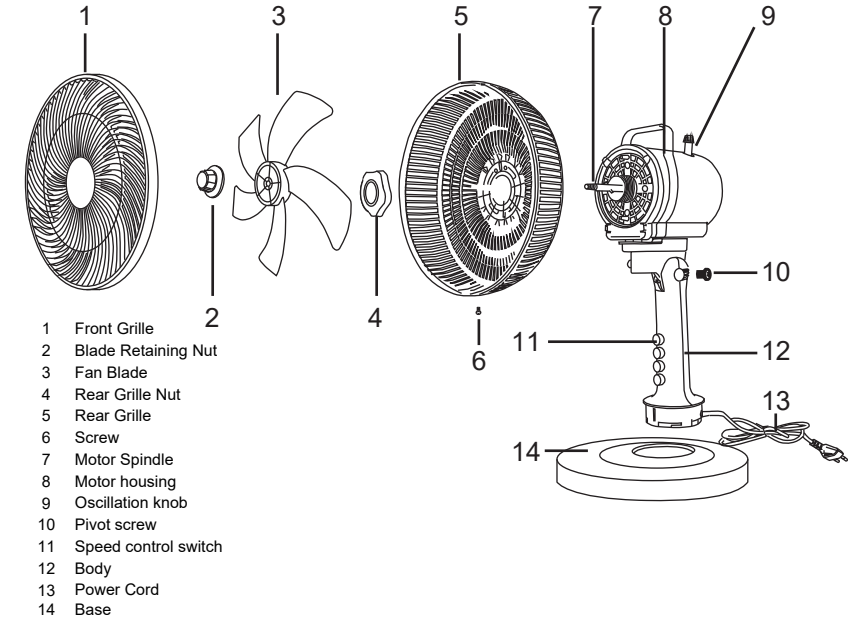

>OPERATION OF THIS PRODUCT

> CAUTION:

> Select a suitable location for the fan, Always chose a safe location in accordance to the safetyrec-ommendations outlined.

> When placing a fan on a table or shelf, always ensure that the power cord not hang where it canaccidentally be pulled and that the unit accidentally fall.

> Do not hang or mount the fan on a wall or ceiling.

>Switch and Speed Control

0- The Fan is switched off

1-The Fan operates at the low speed

2-The Fan operates at the middle speed

3- The Fan operates at the high speed

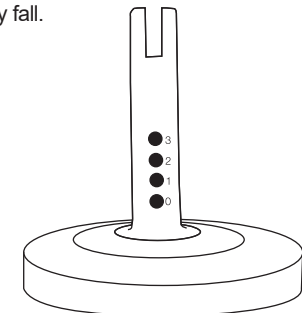

>ASSEMBLY

1. Install rear grille
Align the rear grille to the fan assembly.

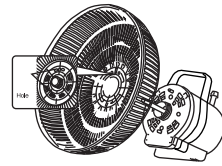

2. Secure the rear grille nut.



3.insert fan blade

(1) Slide the fan blade into the blade slot until it is fully inserted into the shaft pin.

(2) Screw on the blade knob tightly in an anti-clockwise direction.

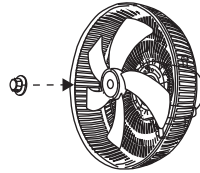

4. Pass the power cord through the base plate

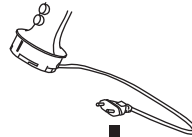

5.Insert the motor assembly into the base plate.



6. Twist clockwise to lock.

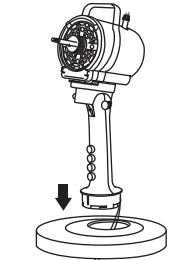

7. Insert the power cable into the base plate
.catch at the rear of the base plate.

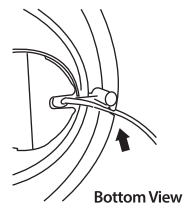
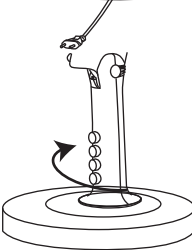

Bottom View

>CLEANING

- > Switch off and unplug from the power supply before assembling or disassembling and cleaning.
- > Keep the air vents at the rear of the main body free from dust or fluff-use a vacuum cleaner to remove these when necessary. Do not probe any opening to remove fluff.
- > Fan component parts should be cleaned using mild soap and a damp cloth or sponge. Do not allow any water or other liquid to enter the motor housing.
- >Thoroughly remove soap foam with clean water.

> **CAUTION: Do not use harsh detergents, chemical cleaners or solvents as they may damage the surface finish of the fan components.**

>WARRANTY

This product is guaranteed against faulty workmanship for a period of twelve months from the original date of purchase. The obligation to the purchaser under this warranty is limited to refund or replace the product when it is returned to the place of purchase. This warranty becomes void if the product has been tampered with, damaged, repaired by unauthorized persons, or becomes faulty in any way by improper use.

This warranty is limited to defects in workmanship, and does not apply to loss or damage caused by abnormal or excessive force of any kind from internal or external source.

**Please attach purchase receipt to this booklet and retain for future use if required.
Proof for purchase is required these warranty conditions**